



Nordic Tug 32-104 "Red Griffon II"

Yacht Particulars

LOA:	32' 2"	Pilot House Headroom:	6' 8"
Beam:	11' 8"	Forward Cabin Headroom:	7' 7"
Draft:	4'	Aft Salon Headroom:	6' 4"
Displacement:	15,000 lbs		
Year:	1997		

Mechanical

Engine: Cummins Diesel 6BT 5.9 220hp
200 Gallon Fuel Capacity
SidePower Bow Thruster

Head & Galley

One (1) Head 30-gallon capacity total
One (1) Shower separate stall
Two (2) Burner Induction Stove Top
Convection Microwave
Hot & cold pressure water with 100-gallon capacity
Hot water capacity 5 gallons

Ground Tackle

Primary Plow anchor with 145' 5/16 BBB Chain
Secondary fluke anchor with 150' rode/chain splice
Lofrans Windlass

Equipment & Inventory

Standard Equipment

110v Shore Power
Electric Bilge Pumps (2)
12v Refrigeration System
AC Reverse Cycle Heat 1 Zone
110v Heater

Docking Gear

Dock Lines (8)
Fenders (5)
Boat Hook

Maintenance Equipment

Basic Tool Kit
Scrub Brush
Hose
General Cleaning Gear

Electronics

Raymarine A127 Chart Plotter
Raymarine EV200 Autopilot
Raymarine Ray60 VHF
Raymarine Quantum Radar
Raymarine AIS Class B
Nebo Tracker
Fusion MS-IP700i Stereo

Miscellaneous Equipment

LED Handheld Flashlights (2)
SmartPlug Shore Power Cord
Smoke Detectors (2)
Carbon Monoxide Detectors (2)

Spare Engine Parts

Oil Filter
Fuel Filter Primary & Racor
Impellor
Engine Belt

Navigation Equipment

Cruising Charts
Dividers
Parallel Rules
Handheld Compass
Regional Charts
Binoculars

Safety Equipment

Throw Raft
Flare Kit
Life Jackets (4) Adult
Signal Horn
Fire Extinguishers (3)
First Aid Kit

Domestic Equipment

Serving Utensils
Place settings (4)
Pots & Pans



Deck Layout

Red Griffon's deck arrangement is simple and efficient. The bow is safely accessible from the pilothouse doors. The windlass is operated from the pilothouse or foot pedals. The cockpit provides access to the sundeck above the main salon via a ladder and access to the swim platform with ladder stepping over the cockpit coaming. The swim platform is accessible over the stern with a telescoping swim ladder. The Sundeck area over the main salon serves as a great area for sunbathing and lounging.

Interior Layout

The floor plan for Red Griffon is ideal for two yet accommodates four. Forward and below is the main stateroom with a large offset berth to starboard. The main cabin has a full height hanging locker to port and complimented with a half locker just aft. Additional storage is beneath added storage. The head is to starboard and aft of the main cabin. Up four stairs, it takes you into the Pilothouse. The Pilothouse has one long seat from the starboard side and stops for the companionway to the main salon and starboard. The helm is starboard. Two windows looking aft provide ventilation. The pilothouse offers access to the side decks via doors to both port and starboard for access forward. Aft of the Pilothouse through the companionway to the port side is the main salon area. The main salon floor plan is the rate "Plan A" with the dinette to port that converts to a large double berth and the galley forward and to starboard. The galley provides an induction stove and microwave, fridge, drawers and cupboards and a single bowl sink. Plentiful storage is found along the starboard side behind cabinet doors. The cockpit is aft through the offset door to starboard.

Interior Floorplan

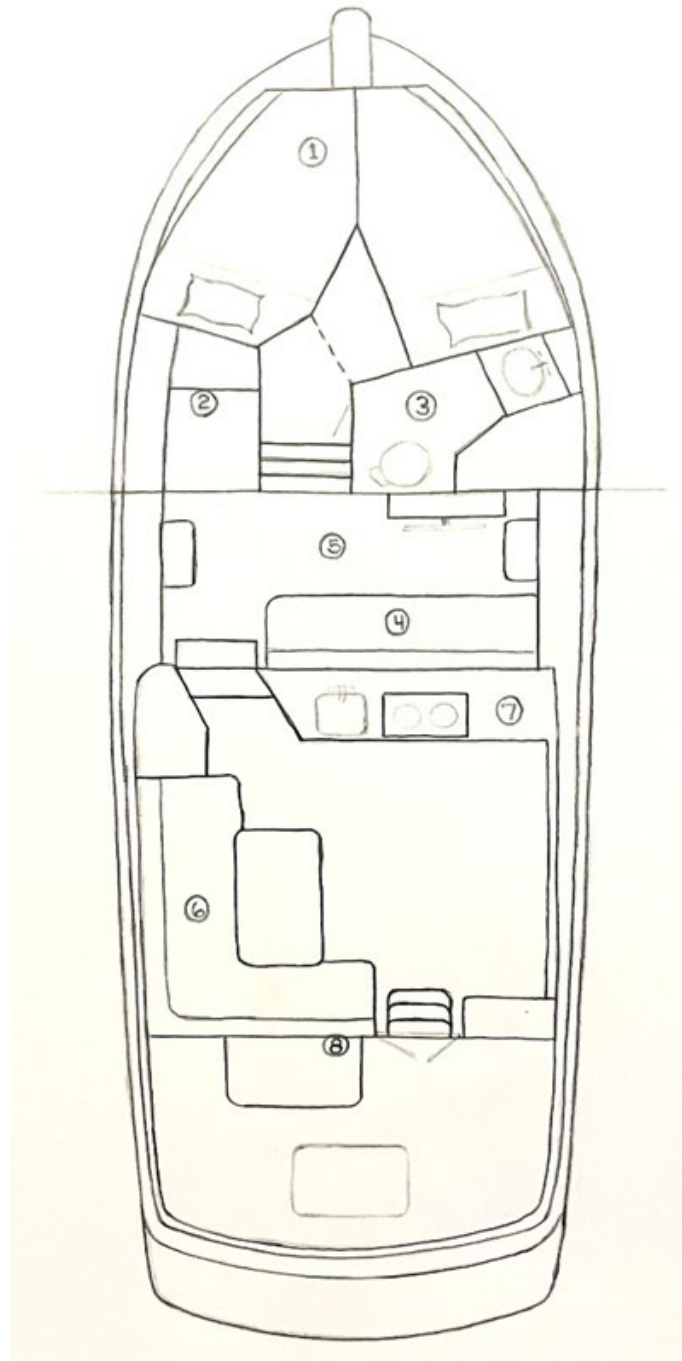

Floorplan Legend

1. Forward Offset Double Berth
2. Full and Half Hanging Closets
3. Head and Separate Shower
4. Helm Bench
5. Pilothouse and Engine Access
6. Settee and Convertible 2nd Berth
7. Refrigerator
8. Cockpit Ladder to Salon Top