



## Nordic Tug 32-104 "Red Griffon II"

### **Yacht Particulars**

LOA:	32' 2"	Pilot House Headroom:	6' 8"
Beam:	11'	Forward Cabin Headroom:	7' 7"
Draft:	4'	Aft Salon Headroom:	6' 4"
Displacement:	15,000 lbs		
Year:	1997		

### **Mechanical**

Engine: Cummins Diesel 6BT 5.9 220hp  
200 Gallon Fuel Capacity  
SidePower Bow Thruster

### **Head & Galley**

One (1) Head 30-gallon capacity total  
One (1) Shower separate stall  
Two (2) Burner Induction Stove Top  
Hot & cold pressure water with 100-gallon capacity  
Hot water capacity 5 gallons

### **Ground Tackle**

Primary Plow anchor with 145' 5/16 BBB Chain  
Secondary fluke anchor with 150' rode/chain splice  
Lofrans Windlass

### **Equipment & Inventory**

#### **Standard Equipment**

110v Shore Power  
Electric Bilge Pumps (2)  
12v Refrigeration System  
AC Reverse Cycle Heat 1 Zone  
110v Heater

#### **Docking Gear**

Dock Lines (8)  
Fenders (5)  
Boat Hook

#### **Maintenance Equipment**

Basic Tool Kit  
Scrub Brush  
Hose  
General Cleaning Gear

#### **Electronics**

Raymarine A127 Chart Plotter  
Raymarine EV200 Autopilot  
Raymarine Ray60 VHF  
Raymarine Quantum Radar  
Raymarine AIS Class B  
Nebo Tracker

Fusion MS-IP700i Stereo

#### **Miscellaneous Equipment**

LED Handheld Flashlights (2)  
SmartPlug Shore Power Cord  
Smoke Detectors (2)  
Carbon Monoxide Detectors (2)

#### **Spare Engine Parts**

Oil Filter  
Fuel Filter Primary & Racor  
Impellor  
Engine Belt

#### **Navigation Equipment**

Cruising Charts  
Dividers  
Parallel Rules  
Handheld Compass  
Regional Charts  
Binoculars

#### **Safety Equipment**

Throw Raft  
Flare Kit  
Life Jackets (4) Adult  
Signal Horn  
Fire Extinguishers (3)  
First Aid Kit

#### **Domestic Equipment**

Serving Utensils  
Place settings (4)  
Pots & Pans



## **Deck Layout**

Red Griffon's deck arrangement is simple and efficient. The bow is safely accessible from the pilothouse doors. The windlass is operated from the pilothouse or foot pedals. The cockpit provides access to the sundeck above the main salon via a ladder and access to the swim platform with ladder stepping over the cockpit coaming. The swim platform is accessible over the stern with a telescoping swim ladder. The Sundeck area over the main salon serves as a great area for sunbathing and lounging.

## **Interior Layout**

The floor plan for Red Griffon is ideal for two yet accommodates four. Forward and below is the main stateroom with a large offset berth to starboard. The main cabin has a full height hanging locker to port and complimented with a half locker just aft. Additional storage is beneath added storage. The head is to starboard and aft of the main cabin. Up four stairs, it brings you into the Pilothouse. The Pilothouse has one long seat from the starboard side and stops for the companionway to the main salon and starboard. The helm is starboard. Two windows looking aft provide ventilation. The pilothouse offers access to the side decks via doors to both port and starboard for access forward. Aft of the Pilothouse through the companionway to the port side is the main salon area. The main salon floor plan is the rate "Plan A" with the dinette to port that converts to a large double berth and the galley forward and to starboard. The galley provides a stove and microwave, fridge, drawers and cupboards and a single bowl sink. Plentiful storage is found along the starboard side behind cabinet doors. The cockpit is aft through the door to starboard.

## **Interior Floorplan**

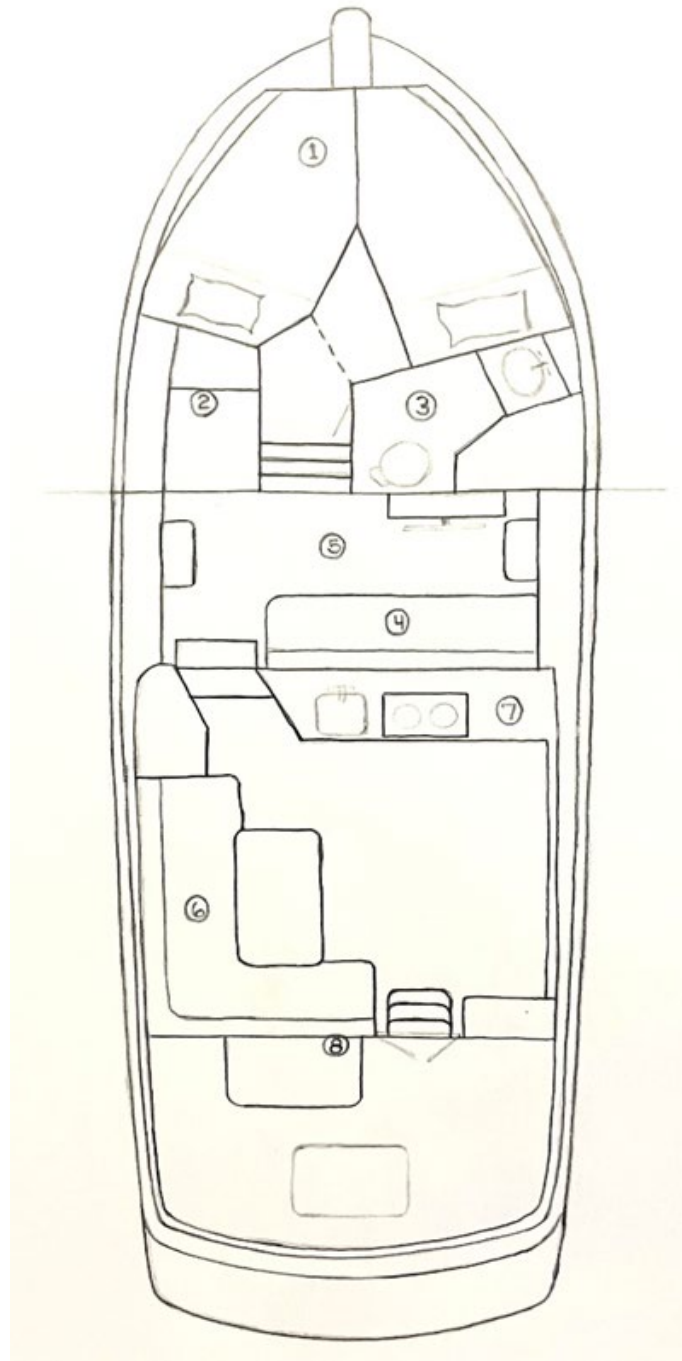

### **Floorplan Legend**

1. Forward Offset Double Berth
2. Full and Half Hanging Closets
3. Head and Separate Shower
4. Helm Bench
5. Pilothouse and Engine Access
6. Settee and Convertible 2<sup>nd</sup> Berth
7. Refrigerator
8. Cockpit Ladder to Salon Top