



American Tug 395-13 "Serenity II"

YACHT PARTICULARS

LOA:	41' 6"	Pilot House Headroom:	6' 8"
Beam:	13' 3"	Aft Salon Headroom:	6' 4"
Draft:	3' 5"	Forward Cabin Headroom:	7' 7"
Displacement:	25,000 lbs.	Head and Shower Headroom:	6' 3"
Fuel Capacity:	400 US Gallons		
Water Capacity:	120. US Gallons		
Waste Capacity:	45 US Gallons		

MECHANICAL

Engine:	Cummins QSB 380hp
Generator:	Onan 9kw
AC / Heat	Three Zone Reverse Cycle
Thrusters:	Sleipner Bow and Stern
Fuel Filtration:	Dual Racor

GROUND TACKLE

Primary Anchor:	Rocna 33lb Vulcan / Rocna Swivel
Primary Rode:	275' 3/16" G4 galvanized chain
Secondary Anchor:	Fortress with 175' three strand with 20' 5/16 chain
Windlass:	Lofrans Tigres 1500w operated from bow and pilot house
Anchor Bridle:	Rocna Snubber

PILOT HOUSE

Raymarine Dual Axiom Chart Plotter
Raymarine EV400 Autopilot
Raymarine AP Wireless Remote
Raymarine Ray60 VHF
Raymarine Quantum Radar
Raymarine AIS Class B
Fusion MS-IP700i Stereo
Caframo Ventilation Fan

GALLEY

Tru-Induction Stovetop
 Samsung Convection Micro
 Hot & Cold Pressure Water
 AC/DC Refrigerator
 AC/DC Freezer
 Double Bowl SS Sink
 Hot Water Capacity 5 gallons.
 Headliner Hinge Down TV

HEAD

Electric Fresh Water Toilet
 Undermount SS Sink
 Separate Shower Stall
 Hot & Cold Cockpit Shower

ANCILLARY EQUIPMENT & INVENTORY

AC Power

30 Amp Shore Power (2)
 110v Heaters Salon and MS
 SmartPlug Shore Power Cords

Docking Gear

Dock Lines (10)
 Fenders (6)
 Boat Hook (2)

Maintenance Equipment

Basic Tool Kit
 Scrub Brush
 Hose
 General Cleaning Gear
 Vacuum

DC Power

Electric Bilge Pumps (3)
 Inverter 2000w
 Fwd PH Window Defroster

Safety Equipment

Ring Buoy
 Flare Kit
 PFD Life Jackets (6) Adult
 PFD Life Jackets (2) Child
 Signal Horn
 Fire Extinguishers (3)
 First Aid Kit
 LED Flashlights (2)

Domestic Equipment

Serving Utensils (4)
 Coffee Maker
 Place settings (4)
 Pots & Pans

Navigation Equipment

Cruising Charts
 Dividers
 Parallel Rules
 Handheld Compass
 Regional Charts
 Binoculars

Spare Engine Parts

Impellor
 Racor / Secondary FF
 Serpentine Belt

Spare Genset Parts

Impellor
 Serpentine Belt
 Racor Fuel Filter
 Secondary Fuel Filter



DECK LAYOUT

The American Tug 395 deck arrangement is simple and efficient. The bow is easily accessible from the pilothouse doors with grab rails above and forward of the door. The 1¼" rails provide solid grab rail integrity and hand holds. The foredeck offers range of motion when moving about tending to dock lines or the anchor and windlass. The windlass is operated from the pilothouse or the foredeck. Moving aft to the cockpit is through the cabin or along the side decks. The cockpit provides access to the upper salon deck above the main salon via a ladder to the port side. The upper salon top is an ideal lounging spot for harbor viewing or catching some sun. A center hinged boarding door provides a secure cockpit while underway and flush access to the swim platform while anchored or dockside. The telescoping swim ladder eases water ingress and egress. There is a small storage locker to starboard and below through the lazarette door.

INTERIOR LAYOUT

The two cabin single head floorplan of the American Tug 395 is well suited for four people with the carryover of two additional people in the convertible settee in the salon for sleeping accommodations. Forward is the master stateroom with a comfortable centerline island berth. The stateroom has a full-length hanging locker to starboard and two half lockers to port. Wing shelves port and starboard side of the berth offer reachable nightstand tops with drawers below. Four drawers at the foot of the berth provide additional storage. Three cubby storage lockers on both port and starboard side of the berth above leading aft from the head of the berth create additional storage. Moving aft from the master stateroom the head is located aft and to port. A single sink vanity with storage sink level behind and below for toiletries and reachable items. The towel rod above the head is readily accessible from the shower or vanity. The shower stall is ample with three shelves for bath products. The second stateroom is adjacent to the head and offers a double berth. Comfortable and roomy, abundant storage and great accent lighting are highlights. Two portholes and a hatch offer great ventilation on those perfect nights. Up four stairs through the companionway is the Pilothouse. Two seats to port and starboard with footrests allow a commanding view ahead through the three forward facing windows. The helm is to starboard. A full width console houses the electronics. Ventilated windows are forward of the PH doors, hatch with Oceanaire screens and sunblock and two aft facing windows looking across the upper salon top. The Pilothouse offers access to the side decks via doors to both port and starboard. Moving aft through the companionway and down three stairs you'll find the main salon and galley area. The main salon consists of the dinette to port that converts to a large double berth and the galley to starboard. The galley provides an induction stovetop and separate convection microwave, separate fridge, freezer, drawers and cupboard and a dual bowl SS corner sink. The 6 large panoramic windows in the salon, 2 of which open for ventilation and have privacy and darkening shades. The cockpit is through the aft hinged door.

INTERIOR FLOORPLAN

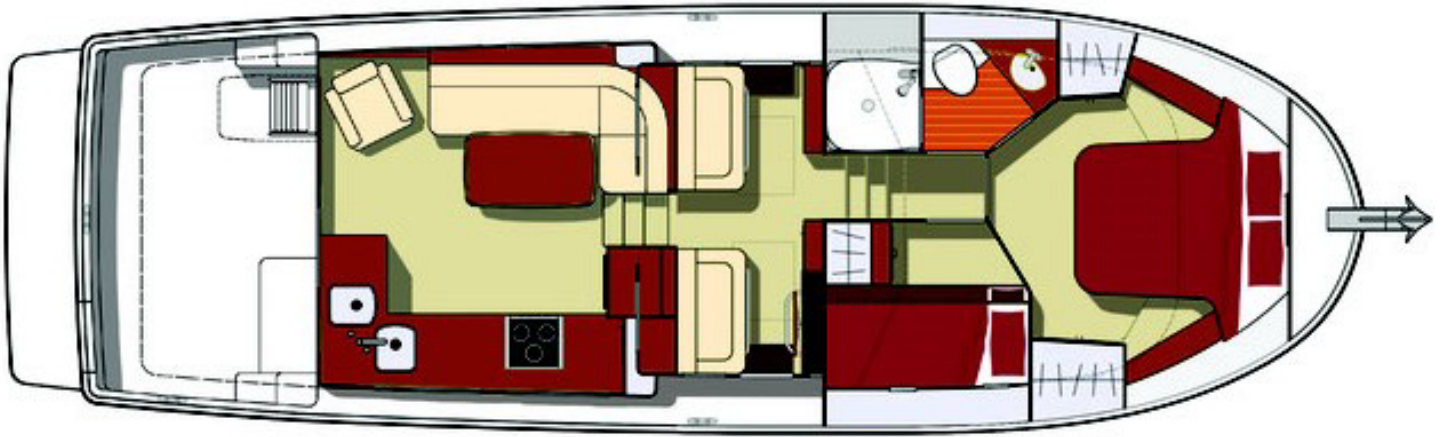

EXTERIOR PROFILE

